

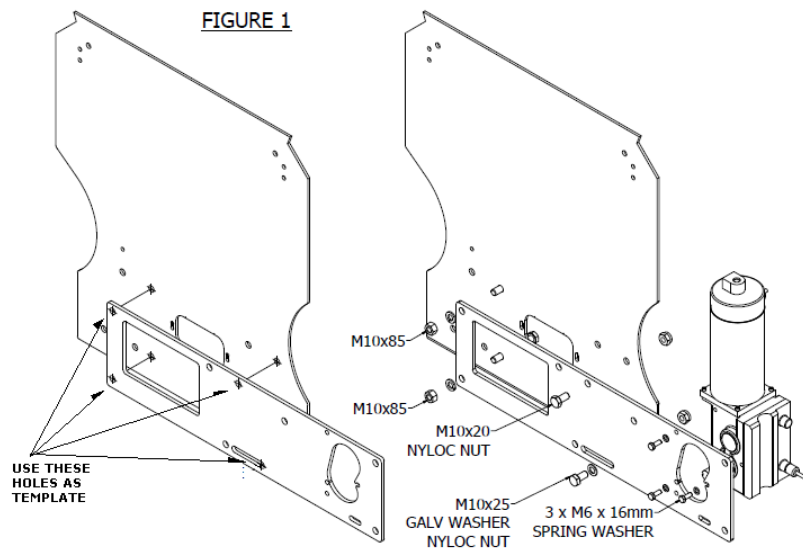

## Double electric kit installation instructions

**FIG 1**

- Detach seed roller drive sprockets and chains.
- Using the motor plates in the electric upgrade kit as a template, mark and drill holes in bins ( x 4 per bin)
- Attach motor plates
- Mount motors to plates – ensure correct motor on correct bin.



**FIG 2**

- Replace seed roller drive sprockets using 30 tooth sprockets (supplied in kit) with 6x16 cap screws.
- Mount drive chains, adjusting as needed with extra link &/or half link supplied. Tension chains with nylon disc on motor plates.

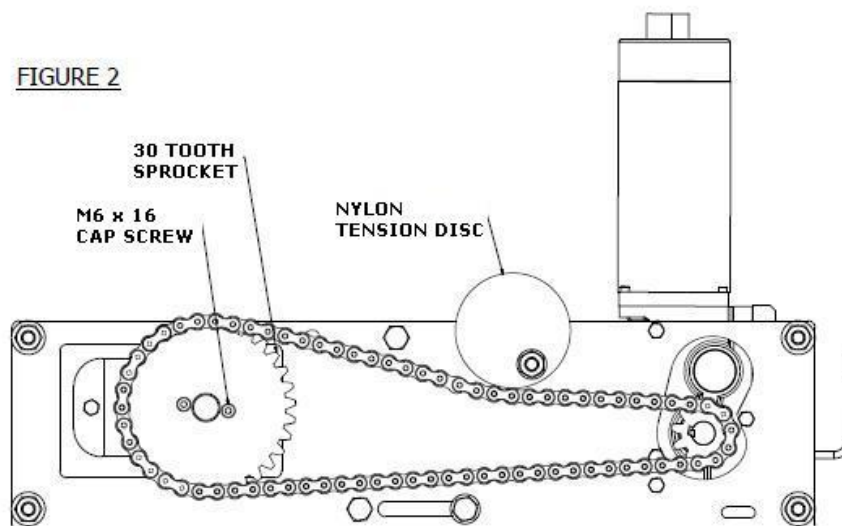

**FIG 3**

- Remove hub meter. Using paper template, mark and drill hole to mount sensor ( 12mm clearance hole)
- Attach 20 tooth starwheel in place of hub meter with 1 inch x 1/2 inch UNF bolt
- Use 10 mm washers to ensure starwheel clears projections
- Adjust sensor to 2 – 3 mm distance of starwheel teeth

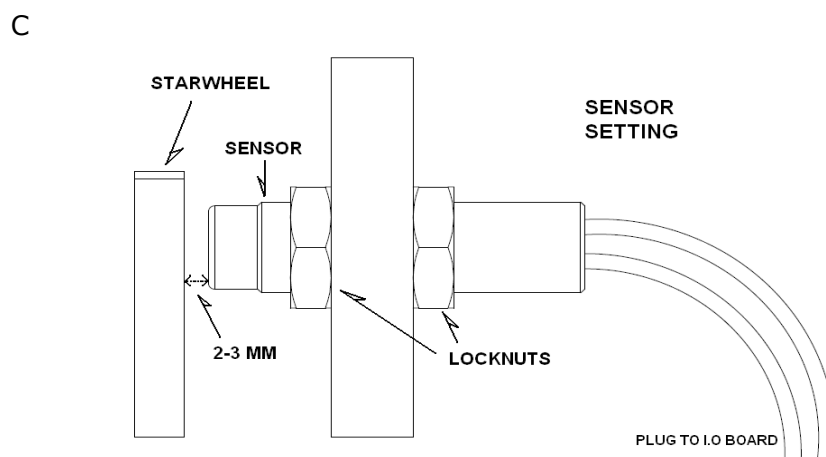
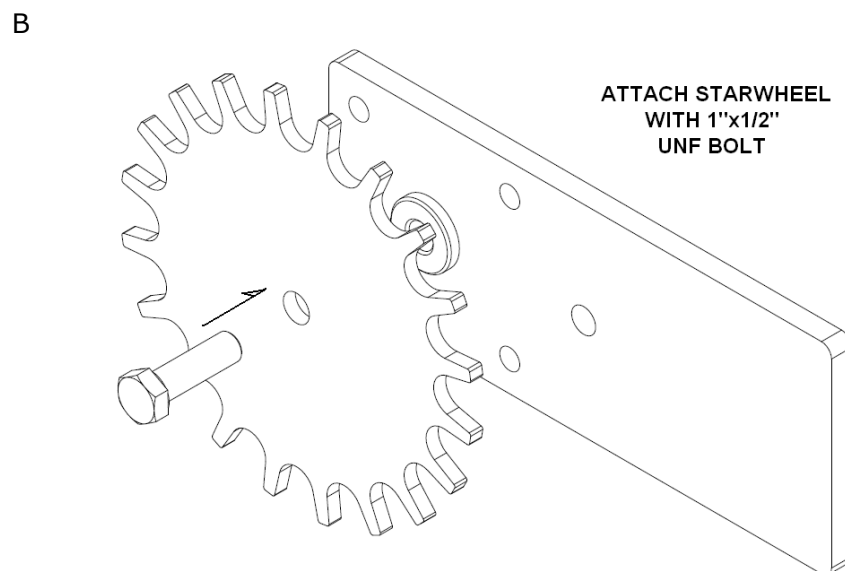
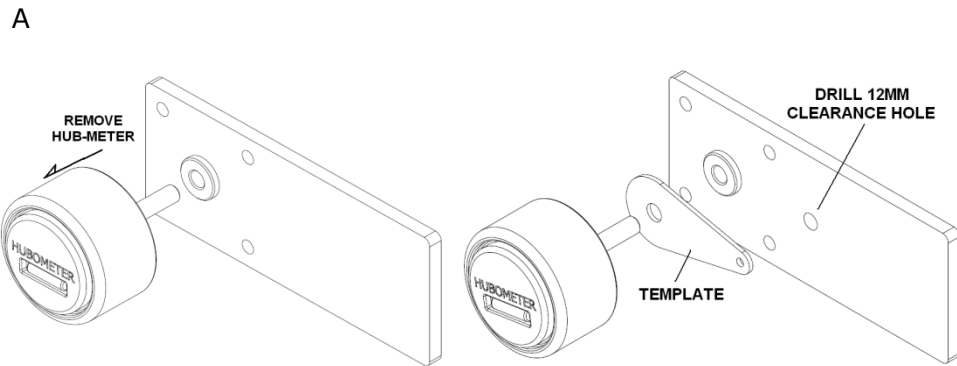

**FIG 4**

- Ensure all earth leads are connected ( I.O board terminal to motor plate, motor plate to bin, motor plate to frame )
- Connect sensor cable
- Connect front to rear loom cable wires as per diagram
- Check all electric connections are secure
- Secure loom cable to frame of drill ( frame only, not to drawbar )

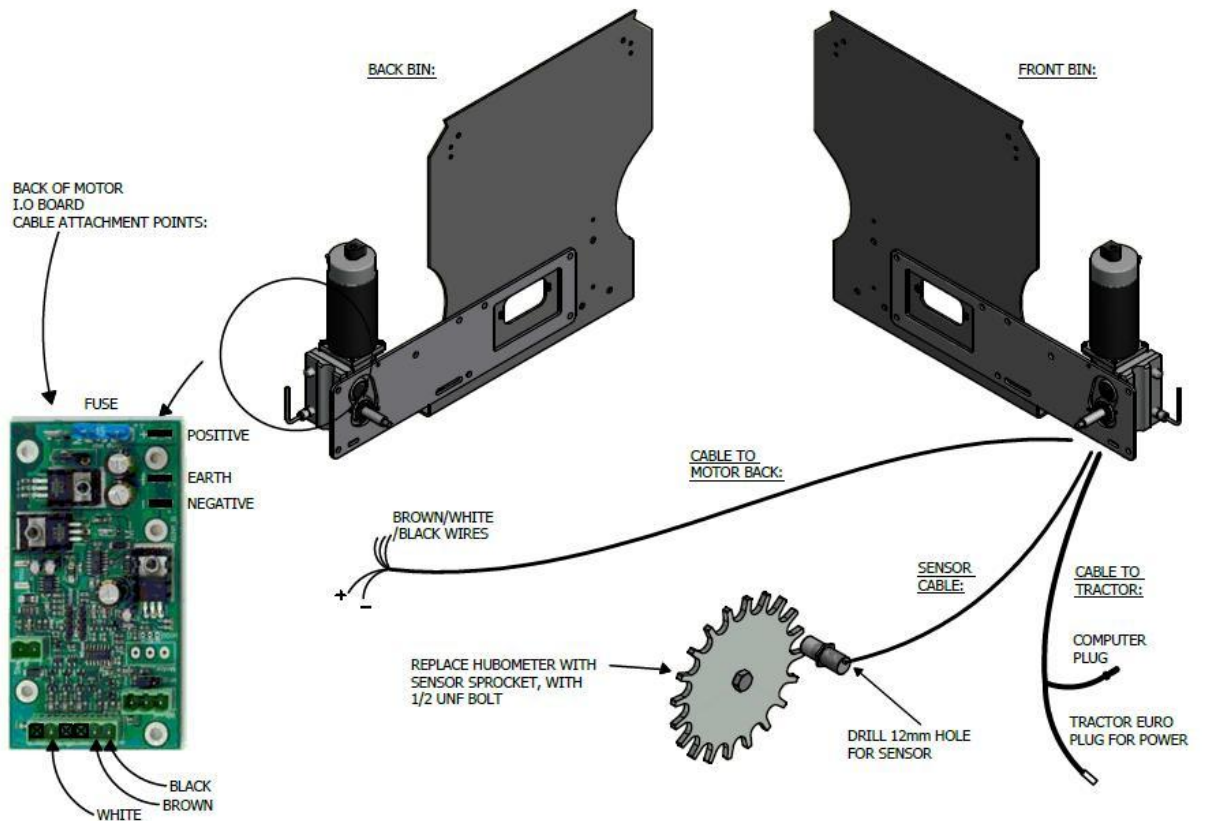
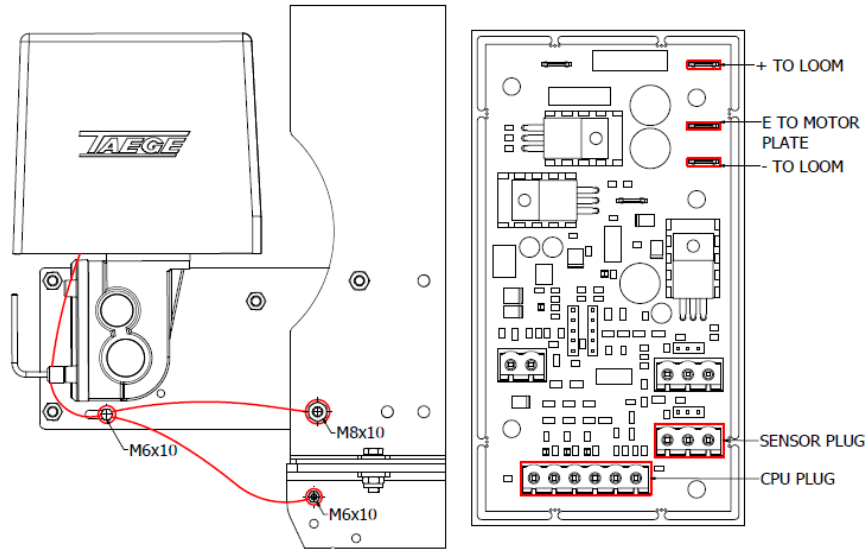
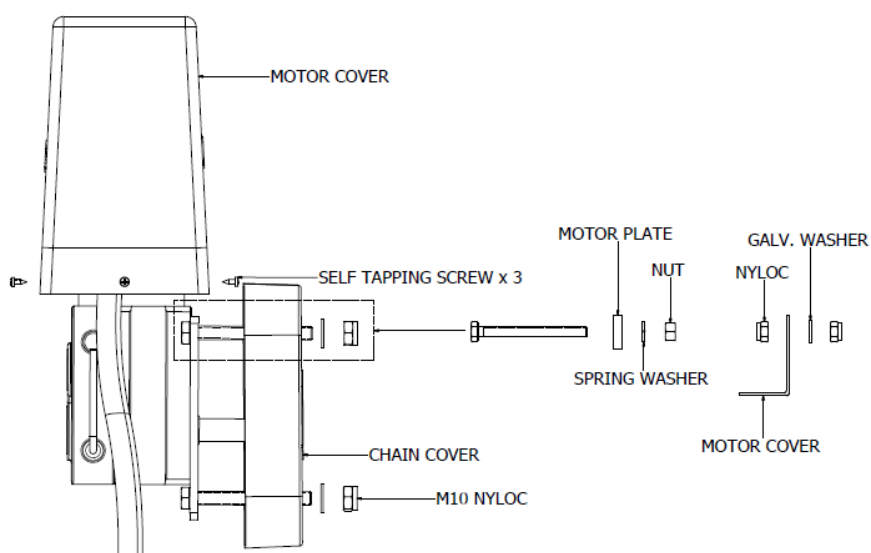

FIG 5

- Place chain covers and motor covers in position and secure
- Test, set parameters and calibrate as per instructions in manual and quick sheet



For any inquiries or questions regarding parts or installation of this product, contact TAEGE engineering parts dept, 021865151 mon – fri during business hours, or e-mail [parts@taege.com](mailto:parts@taege.com)

Further information on Taege products can be found at [www.taege.com](http://www.taege.com)

Taege reserve the right to change parts/design/prices without notice.